

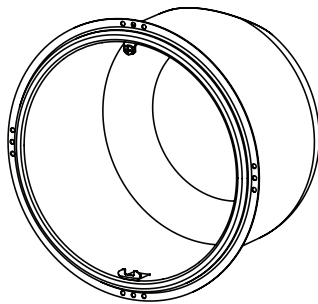

Installation Manual

Jandy Housing for Wet Niche Fixtures

For Gunite Pool and Spa Installations -
Plastic Model Nos. PLNICLRG and PLNICSM
and Stainless Steel Model Nos. SSNICLRG1X and
SSNICSM1X



SSNICLRG1R (REAR)
SSNICLRG1S (SIDE)

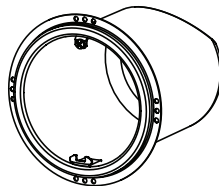

SSNICSM1R (REAR)
SSNICSM1S (SIDE)

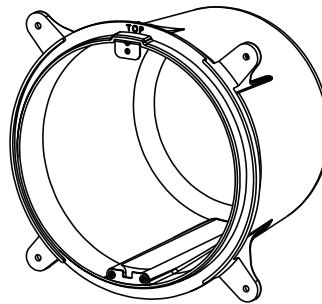

PLNICLRG

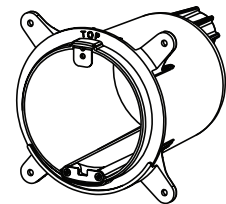

PLNICSM

WARNING

FOR YOUR SAFETY - This product must be installed and serviced by a professional pool/spa service technician. The procedures in this manual must be followed exactly. Failure to follow warning notices and instructions may result in property damage, serious injury, or death.

IMPORTANT SAFETY INSTRUCTIONS PERTAINING TO A RISK OF FIRE, ELECTRIC SHOCK, OR INJURY TO PERSONS READ AND FOLLOW ALL INSTRUCTIONS

When installing and using this equipment, basic safety precautions should always be followed, including the following:

WARNING

RISK OF ELECTRICAL SHOCK OR ELECTROCUTION. This underwater niche must be installed by a licensed or certified electrician in accordance with the National Electrical Code and applicable local codes and ordinances. Improper installation will create an electrical hazard, which could result in death or serious injury to pool or spa users, installers, or others due to electrical shock, and may also cause damage to property. Read and follow the specific instructions below.

WARNING

Before installing this underwater niche, read and follow all warning notices and instructions accompanying this niche. Failure to follow safety warnings and instructions can result in severe injury, death, or property damage. Call (707) 776-8200 or visit our website www.jandy.com for additional free copies of these instructions.



ATTENTION INSTALLER: This manual contains important information about the installation and safe use of this product. This information should be given to the owner/operator of this equipment.

NOTICE

The Jandy Pool and Spa niches are intended for installation in fresh water and salt water swimming pools and spas. It is important to ensure that the lights in which the niches are installed are intended for their appropriate application, either fresh water or salt water.

Jandy Compatible Light Fixture Part Numbers

Use the large niches (SSNICLRG1X and PLNICLRG) with the following Jandy Lights:

P/N JPL120XXX
 P/N JPL12XXX
 P/N CPHVXXXXXXXXXX
 P/N CPLVXXXXXXXXXX
 P/N WPHVXXXXXXXXXX
 P/N WPLVXXXXXXXXXX

Use the small niches (SSNICSM1X AND PLNICSM) with the following Jandy Lights:

P/N JSL120XXX
 P/N JSL12XXX
 P/N WSHVXXXXXXXXXX
 P/N WSLVXXXXXXXXXX

SAVE THESE INSTRUCTIONS

This document gives instructions for installing the Jandy Niche for gunite pool and spa installations. The instructions must be followed exactly. Read through the instructions completely before starting the procedure.

The Jandy Niche is designed to be installed in the pool or spa walls.

1. Installation During New Construction

Ensure that the pool or spa meets the requirements of the current National Electrical Code and all local codes and ordinances. A licensed or certified electrician must install the electrical system to meet or exceed those requirements before the Niche (fixture housing) is installed. Some of the requirements of the National Electrical Code, which the pool and spa electrical systems must meet, are as follows:

- The lighting circuit must have a Ground Fault Circuit Interrupter (GFCI) for 120 volt models, and must have an appropriately rated circuit breaker.
- The Junction Box (or, for 12 volt models, the low voltage transformer) must be located at least eight (8) inches above water level, at least four (4) inches above ground level, and at least four (4) feet from the edge of the pool or spa. See Figure 1.
- The light fixture and all metal items within five (5) feet of the pool or spa must be properly electrically bonded to a reliable point of grounding. Seal the wire/lug connection with a listed sealant.

- The wet niche must be properly installed so that the top edge of the underwater light's lens is at least 18 inches below (not more than 48 inches below in Canada) the surface of the water in the pool or spa. See Figure 1.
- The wet niche must be properly electrically bonded and grounded via the No. 8 AWG ground connector located at the rear of the niche. See Figure 1.

2. Installation Instructions for Plastic Niches (PLNICLRG AND PLNICSM)

- Locate a position for the installation of the niche and light fixture so that the top of the lens will be a minimum of 18" below normal water level. Position niche between adjacent rebar so that the niche is held on four sides by sections of rebar. It may be necessary to add sections of rebar or to move existing sections in order to secure niche in place.
- Attach conduit to the back of niche using the proper PVC/CPVC primer and glue. See Figure 2. A 1" PVC 45 degree sweep elbow is included with the niche to direct the conduit pipe upwards toward the junction box. A 3/4" reducer is also included with the niche to permit the use of 3/4" conduit pipe. Make sure to follow the primer and glue manufacturer's instructions for the preparation procedures and curing times.

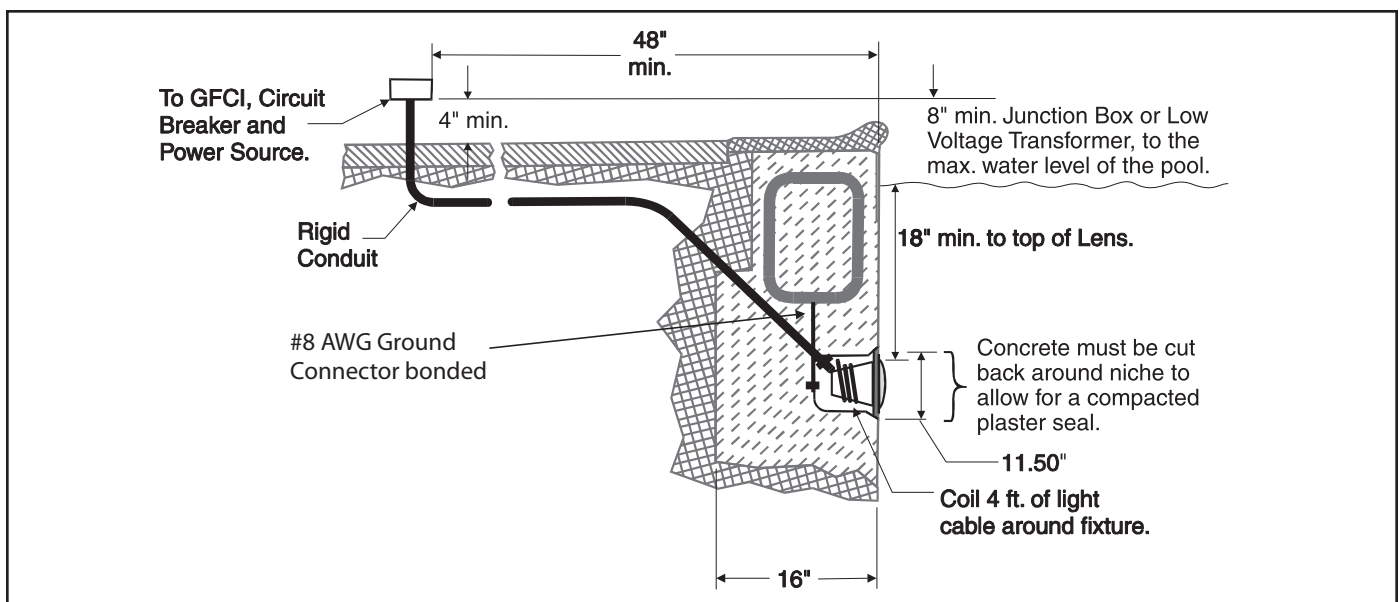

Figure 1. Pool Niche Installation

- c. Using tie wire, attach the niche housing to the rebar. Jandy models PLNICLRG and PLNICSM have four (4) outer flanges with 1/4" holes which should be used to route the tie wire through to secure the niche to the rebar. Ensure that the niche is the proper forward distance from the rebar so that the top surface of the niche will be flush with the finish surface.

NOTE: Be sure to orient the niche so that the 'TOP' marking of the niche is in the 12 o'clock position.

- d. Connect #8 AWG (#6 AWG for Canadian installations) bonding wire from rebar to rear grounding lug of niche (outside of the niche).
- e. If nonmetallic conduit is used, a #8 AWG (#6 AWG for Canadian installations) bonding wire is required to run through conduit from the junction box to the bonding/grounding lug inside of niche. Seal the wire/lug connection with a listed sealant. See Figure 3.
- f. The outside bonding connection must be inspected before the concrete pouring/shooting operation. It is also necessary to keep concrete or gunite from hardening on the outer edge and flange of the niche during pouring/shooting.
- g. Remove the nylon screw and attach plastic niche cover to opening of niche prior to the concrete/gunite pouring/shooting operation. See Figure 4. The cover prevents concrete or gunite from entering the inside of the niche, during the pouring/shooting operation.
- h. Once the concrete/gunite has completely dried and prior to plastering, tear outer portion away from cover. Plaster up to the top edge of niche.
- i. A PVC 1" Plug is provided with niche for pressure testing of conduit line before installation of light fixture.

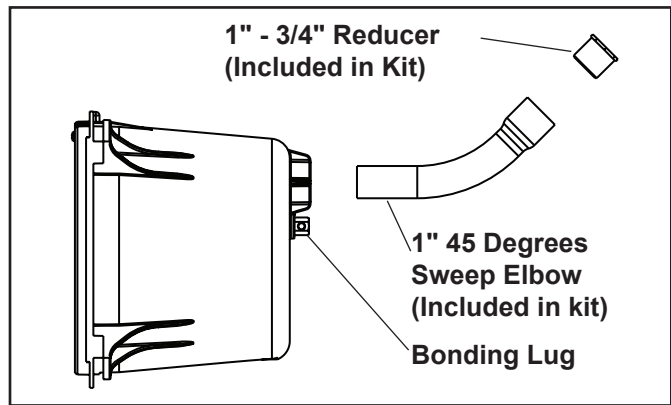

Figure 2. Plastic Niche Installation

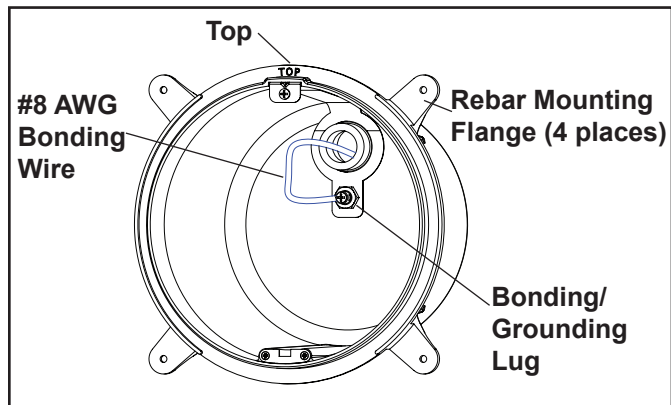

Figure 3. Plastic Niche Bonding Wire Installation

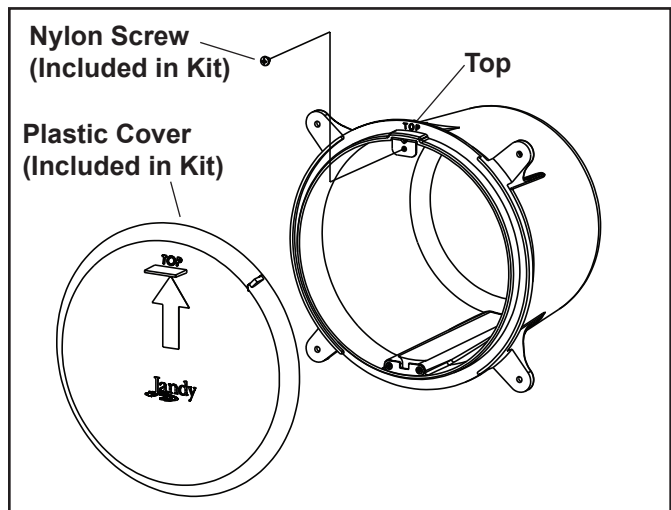

Figure 4. Plastic Niche Cover and Nylon Screw for Plastic Niche

3. Installation Instructions for Stainless Steel Niches (SSNICLRG1X AND SSNICSM1X)

- a. Locate a position for the installation of the niche and light fixture so that the top of the lens will be a minimum of 18" below normal water level. Position niche between adjacent rebars so that the niche is held on four sides by sections of rebar. It may be necessary to add sections of rebar or to move existing sections in order to secure niche in place.
- b. Attach conduit to the niche using the proper thread sealant. A threaded 1" NPT connection is attached to the back of the niche. A threaded 1" - 1/2" NPT reducer is included with the niche to permit the use of 1/2" metallic conduit. If nonmetallic conduit is used, then a threaded bushing will be required (not included with niche).
- c. Using tie wire, attach the niche housing to the rebar. Ensure that the niche is the proper forward distance from the rebar so that the top surface of the niche will be flush with the finish surface.

NOTE: Be sure to orient the niche so that the 'TOP' marking of the niche is in the 12 o'clock position.

- d. Connect bonding wire from rebar to rear bonding lug of niche (outside of the niche).
- e. If rigid nonmetallic conduit is used, a #8 AWG (#6 AWG for Canadian installations) bonding wire is required to run through conduit from the junction box to the bonding/grounding lug inside of niche. Seal the wire/lug connection with a listed sealant. See Figure 6. If metallic conduit is used a bonding wire is not required.
- f. The outside bonding connection must be inspected before the concrete pouring/shooting operation. It is also necessary to keep concrete or gunite from hardening on the outer edge and flange of the niche during pouring/shooting.
- g. Remove the nylon screw and attach plastic niche cover to opening of niche prior to the concrete/gunite pouring/shooting operation. See Figure 7. The cover prevents concrete or gunite from entering the inside of the niche, during the pouring/shooting operation.

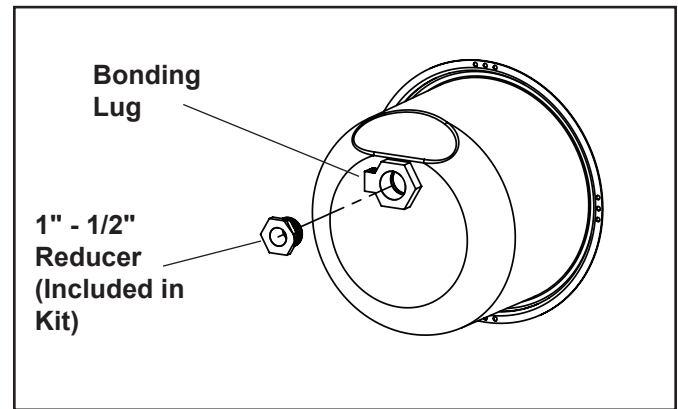

Figure 5. Stainless Steel Niche Kit Components

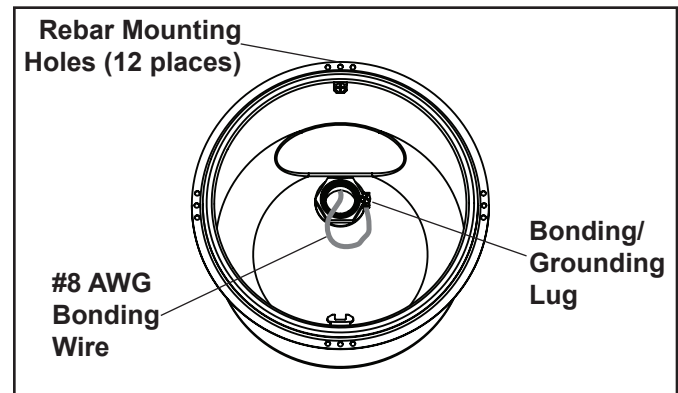

Figure 6. Stainless Steel Niche Bonding Wire Installation

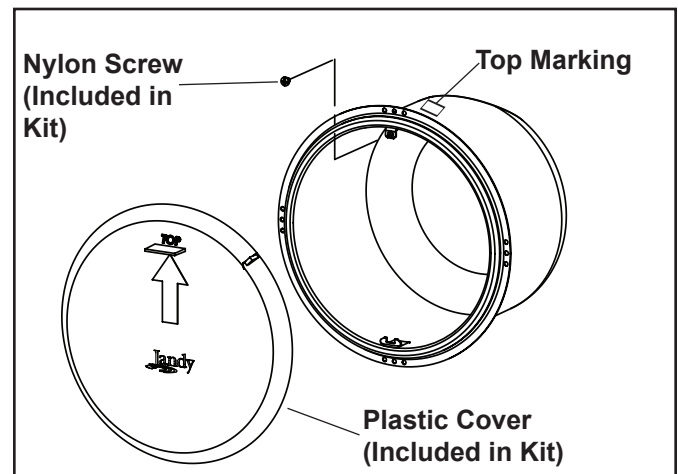

Figure 7. Plastic Niche Cover and Nylon Screw for Stainless Steel Niche

- h. Once the concrete/gunite has completely dried and prior to plastering, tear outer portion away from cover. Plaster up to the top edge of niche.

4. Part Lists

The Parts Lists and Exploded View are shown on the next page.

Table 1. Parts List - Plastic Pool and Spa Niche (PLNICLRG and PLNICSM)

<u>Item No.</u>	<u>Part Number</u>	<u>Description</u>	<u>Qty.</u>
1	R0460800	Niche Misc, Kit, Plastic, Pool and Spa 10-24 Screws (Grounding Lug) 10-24 Nylon Screw (Gunite Protection) 1" Threaded Plug 1" 45° Sweep Elbow 1" to 3/4" Reducer	2 1 1 1 1
2	R0461000	Niche Cover R-Kit, Pool Niche Cover, Pool	1
3	R0461100	Niche Cover R-Kit, Spa Niche Cover, Spa	1

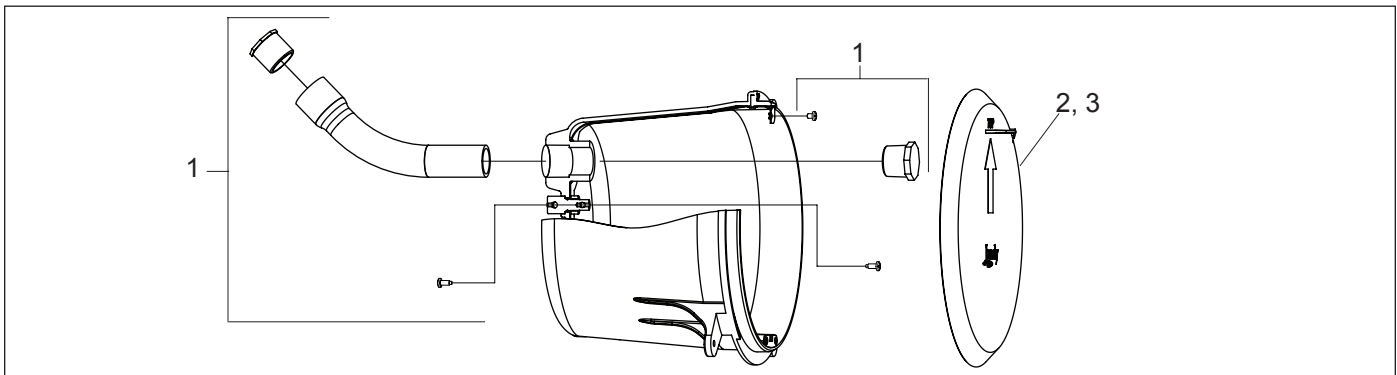
**Figure 8. Plastic Pool and Spa Niche (PLNICLRG and PLNICSM) Exploded View****Table 2. Parts List - Stainless Steel Pool and Spa Niche (SSNICLRG1X and SSNICSM1X)**

<u>Item No.</u>	<u>Part Number</u>	<u>Description</u>	<u>Qty.</u>
1	R0460900	Niche Misc, Kit, Stainless Steel, Pool and Spa 10-24 Screws (Grounding Lug) 10-24 Nylon Screw (Gunite Protection) 1" to 1/2" Threaded Reducer	2 1 1
2	R0461000	Niche Cover R-Kit, Pool Niche Cover, Pool	1
3	R0461100	Niche Cover R-Kit, Spa Niche Cover, Spa	1

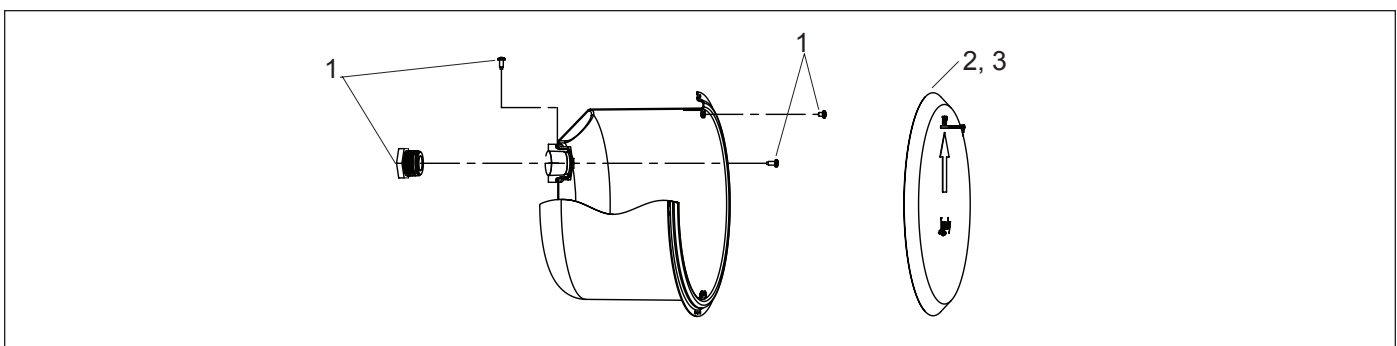
**Figure 9. Stainless Steel Pool and Spa Niche (SSNICLRG1X and SSNICSM1X) Exploded View**

NOTES

LIMITED WARRANTY

Thank you for purchasing Jandy® pool and spa products. Jandy Pool Products, Inc. (manufacturer of Jandy products), warrants all parts to be free from manufacturing defects in materials and workmanship for a period of one year from the date of retail purchase, with the following exceptions:

- AquaLink® RS units installed with Jandy Surge Protection Kits will be covered for two years.
- NeverLube® valves are warranted for the life of pool and/or spa on which they were originally installed.

This warranty is limited to the first retail purchaser, is not transferable, and does not apply to products that have been moved from their original installation sites. The liability of Jandy Pool Products, Inc. shall not exceed the repair or replacement of defective parts and does not include any costs for labor to remove and reinstall the defective part, transportation to or from the factory, and any other materials required to make the repair. This warranty does not cover failures or malfunctions resulting from the following:

1. Failure to properly install, operate or maintain the product(s) in accordance with our published Installation, Operation and Maintenance Manuals provided with the product(s).
2. The workmanship of any installer of the product(s).
3. Not maintaining a proper chemical balance in your pool and/or spa [pH level between 7.2 and 7.8, Total Alkalinity (TA) between 80 to 120 ppm, Total Dissolved Solids (TDS) less than 2000].
4. Abuse, alteration, accident, fire, flood, lightning, rodents, insects, negligence or acts of God.
5. Scaling, freezing, or other conditions causing inadequate water circulation.
6. Operating the product(s) at water flow rates outside the published minimum and maximum specifications.
7. Use of non-factory authorized parts or accessories in conjunction with the product(s).
8. Chemical contamination of combustion air or improper use of sanitizing chemicals, such as introducing sanitizing chemicals upstream of the heater and cleaner hose or through the skimmer.
9. Overheating; incorrect wire runs; improper electrical supply; collateral damage caused by failure of O-Rings, DE grids, or cartridge elements; or damage caused by running the pump with insufficient quantities of water.

LIMITATION OF LIABILITY:

This is the only warranty given by Jandy Pool Products, Inc. No one is authorized to make any other warranties on Jandy Pool Products, Inc.'s behalf. **THIS WARRANTY IS IN LIEU OF ALL OTHER WARRANTIES, EXPRESSED OR IMPLIED, INCLUDING BUT NOT LIMITED TO ANY IMPLIED WARRANTIES OF FITNESS FOR A PARTICULAR PURPOSE AND MERCHANTABILITY. JANDY POOL PRODUCTS, INC., EXPRESSLY DISCLAIMS AND EXCLUDES ANY LIABILITY FOR CONSEQUENTIAL, INCIDENTAL, INDIRECT OR PUNITIVE DAMAGES FOR BREACH OF ANY EXPRESSED OR IMPLIED WARRANTY.** This warranty gives you specific legal rights. You may also have other rights which vary by state or province.

WARRANTY CLAIMS:

For prompt warranty consideration, contact your dealer and provide the following information: proof of purchase, model number, serial number and date of installation. The installer will contact the factory for instructions regarding the claim and to determine the location of the nearest designated service center. If the dealer is not available, you can locate a service center in your area by visiting www.jandy.com or by calling our technical support department at (707) 776-8200 extension 260. All returned parts must have a Returned Material Authorization number to be evaluated under the terms of this warranty.



Jandy Pool Products, Inc.
6000 Condor Drive, Moorpark, CA, USA 93021 • 707.776.8200 FAX 707.763.7785

Litho in U.S.A. © Jandy Pool Products, Inc. 0706